

LOCATION

8469 Southern Blvd - Building 1, Boardman, OH 44512

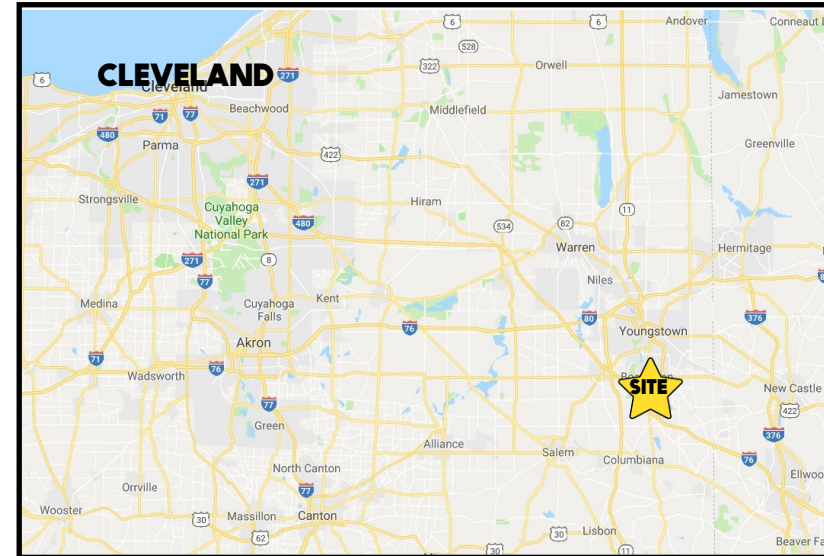

HIGHLIGHTS

- Total 23,274 SF; 18,882 SF warehouse + 4,392 SF office
- 2 separate garage spaces (11,200 + 7,682)
- 6 Overhead cranes: 2 ton – 10 ton
- 2 drive-in doors
- Just south of McClurg Rd, by Mercy Health
- Easy access to I-680

Office: 330.757.4889 | Fax: 330.294.5622 | 3830 Starr Centre Dr, Suite 2, Canfield, OH 44406

TRAFFIC

Southern Blvd = 3,659 VPD

CONTACT

DON THOMAS

501.269.3827

dthomas@platzrealtygroup.com

www.PLATZREALTYGROUP.com



Office: 330.757.4889 | Fax: 330.294.5622 | 3830 Starr Centre Dr, Suite 2, Canfield, OH 44406

www.PLATZREALTYGROUP.com

The information presented was obtained from sources believed to be true and reliable. The Platz Realty Group makes no warranties or guarantees to the accuracy of the information.



Office: 330.757.4889 | Fax: 330.294.5622 | 3830 Starr Centre Dr, Suite 2, Canfield, OH 44406

www.PLATZREALTYGROUP.com

The information presented was obtained from sources believed to be true and reliable. The Platz Realty Group makes no warranties or guarantees to the accuracy of the information.

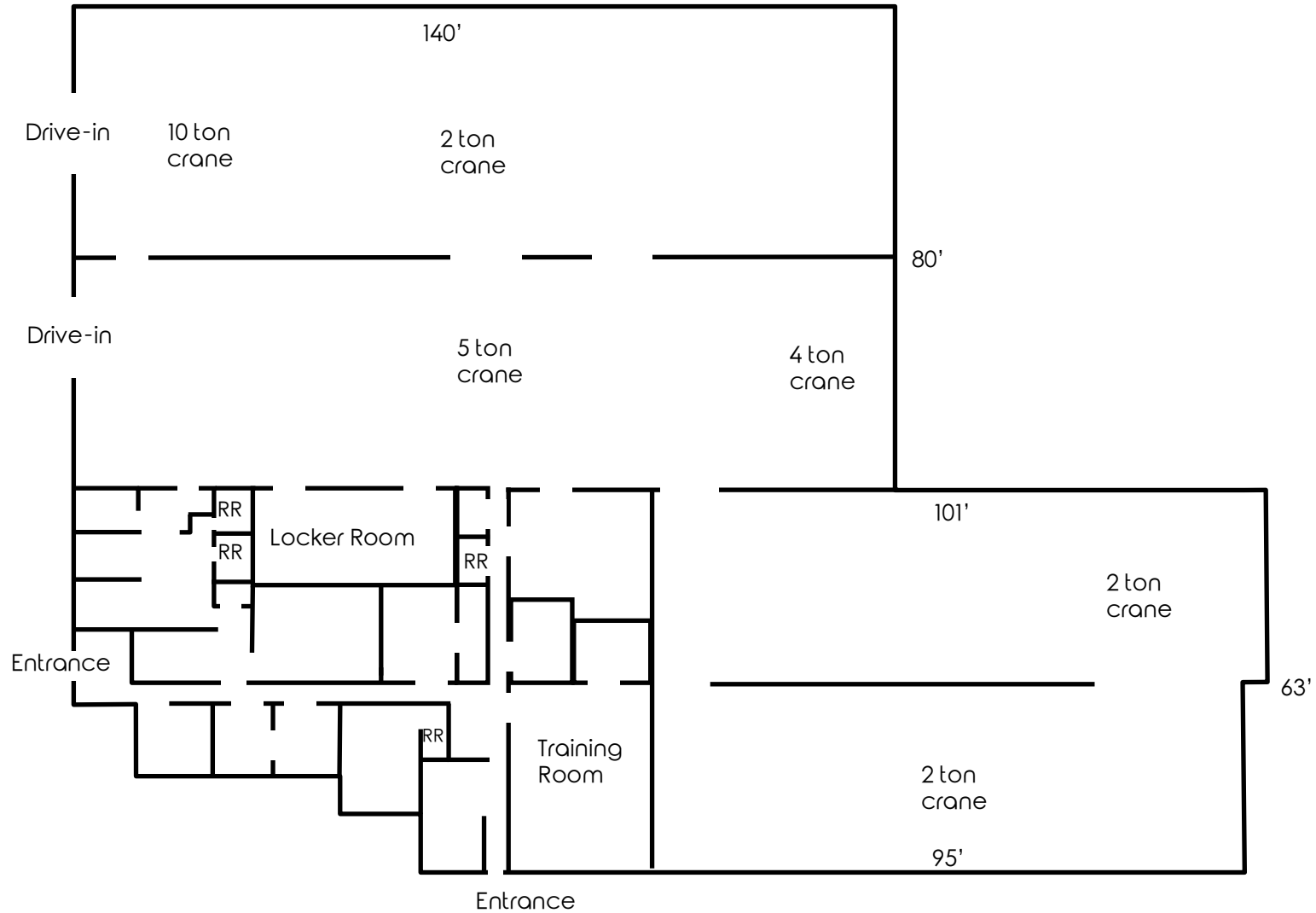

Office: 330.757.4889 | Fax: 330.294.5622 | 3830 Starr Centre Dr, Suite 2, Canfield, OH 44406



Office: 330.757.4889 | Fax: 330.294.5622 | 3830 Starr Centre Dr, Suite 2, Canfield, OH 44406

www.PLATZREALTYGROUP.com

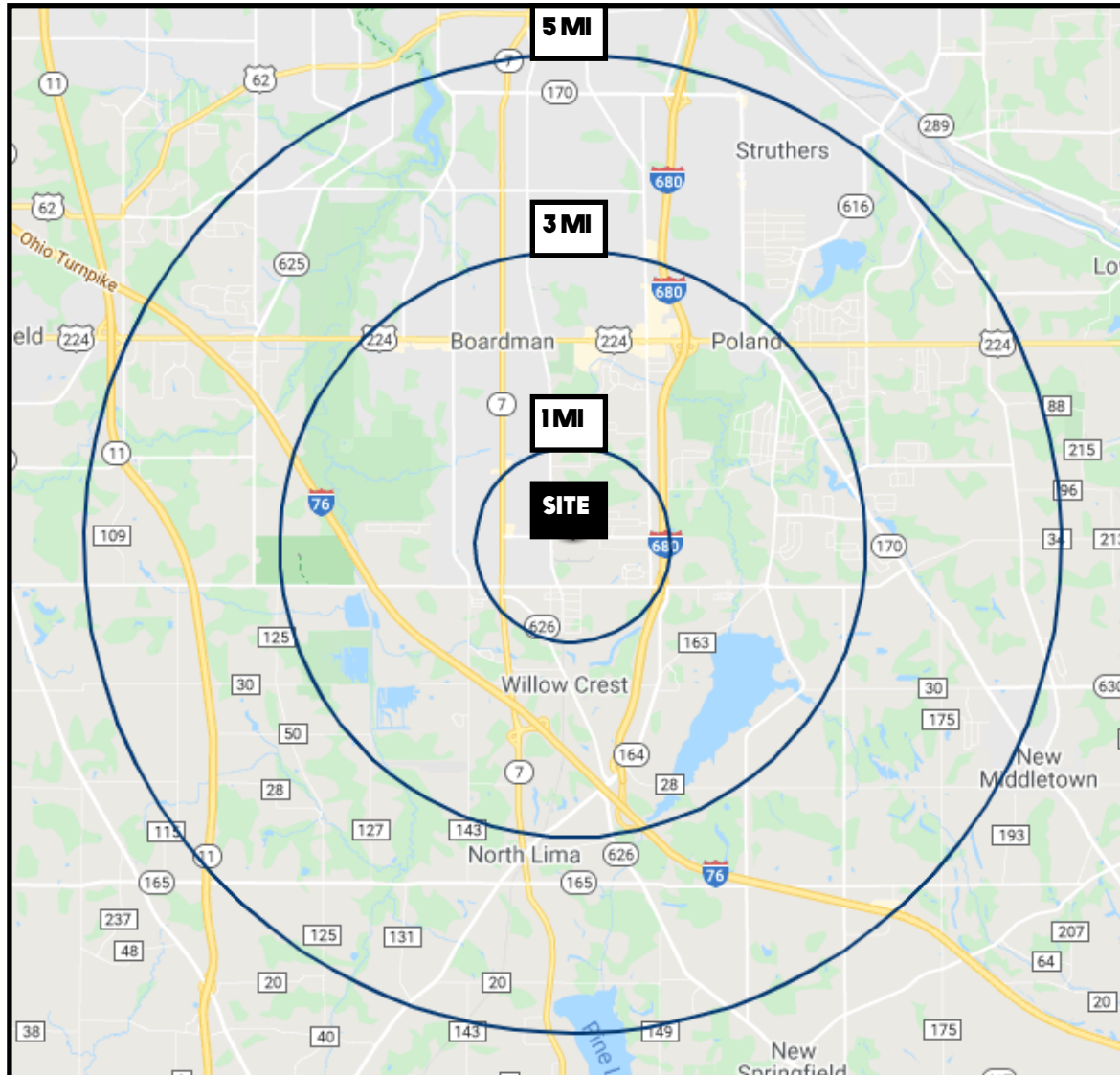

DEMOGRAPHICS	1 MI	3 MI	5 MI
POPULATION	2,699	26,641	80,437
HOUSEHOLDS	1,253	11,553	33,978
MEDIAN AGE	53	48	45
AVERAGE HH INCOME	\$69,190	\$82,976	\$77,357

SITE INFORMATION

LOCATION	Boardman Township Mahoning County
SIZE	23,274 SF; 18,882 SF ware- house + 7,682 SF office
DOORS	2 drive-in doors
CRANES	6 cranes: 3) 2 ton, 4 ton, 5 ton, 10 ton
POWER	480 v 3 Phase
ZONING	Industrial
RENT	\$6.75/SF Gross

Office: 330.757.4889 | Fax: 330.294.5622 | 3830 Starr Centre Dr, Suite 2, Canfield, OH 44406