

LOCATION

7206 Market St, Boardman, OH 44512

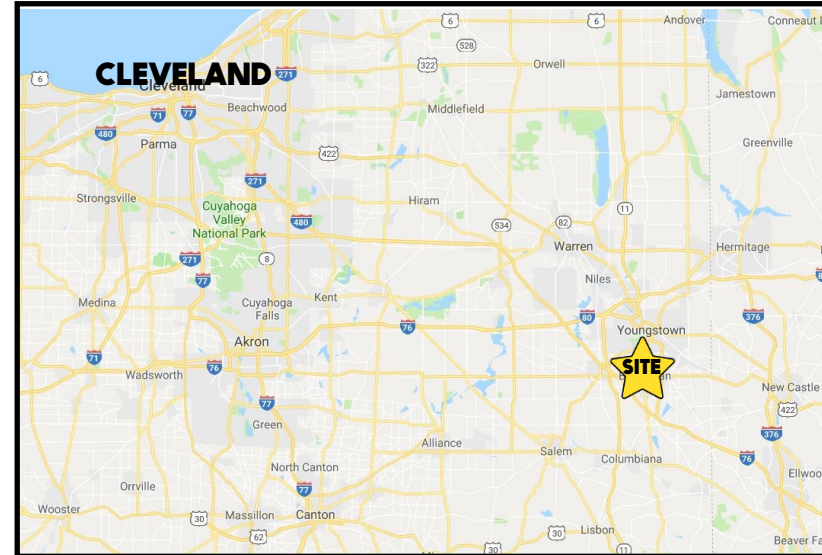

HIGHLIGHTS

- Professional office space on Market St
- Shared access to conference room
- Just north of US 224 / Southern Park Mall
- Great street signage
- Ample front door parking

TRAFFIC

Market St = 19,700 VPD

CONTACT

BILL KUTLICK

330.565.5701

bkutlick@platzrealtygroup.com

Office: 330.757.4889 | Fax: 330.294.5622 | 3830 Starr Centre Dr, Suite 2, Canfield, OH 44406

www.PLATZREALTYGROUP.com



Office: 330.757.4889 | Fax: 330.294.5622 | 3830 Starr Centre Dr, Suite 2, Canfield, OH 44406

www.PLATZREALTYGROUP.com

The information presented was obtained from sources believed to be true and reliable. The Platz Realty Group makes no warranties or guarantees to the accuracy of the information.

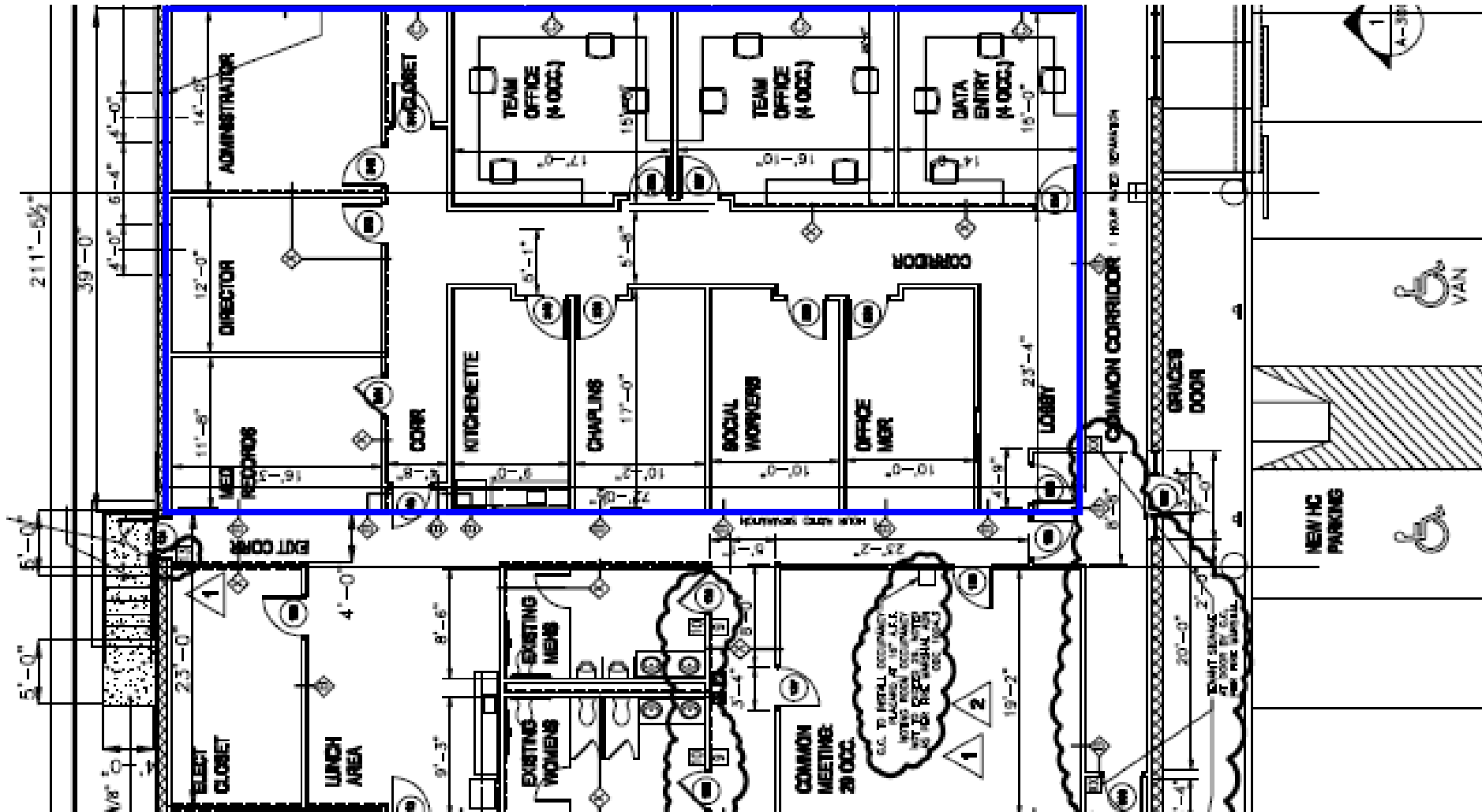

Office: 330.757.4889 | Fax: 330.294.5622 | 3830 Starr Centre Dr, Suite 2, Canfield, OH 44406

www.PLATZREALTYGROUP.com



Office: 330.757.4889 | Fax: 330.294.5622 | 3830 Starr Centre Dr, Suite 2, Canfield, OH 44406

www.PLATZREALTYGROUP.com

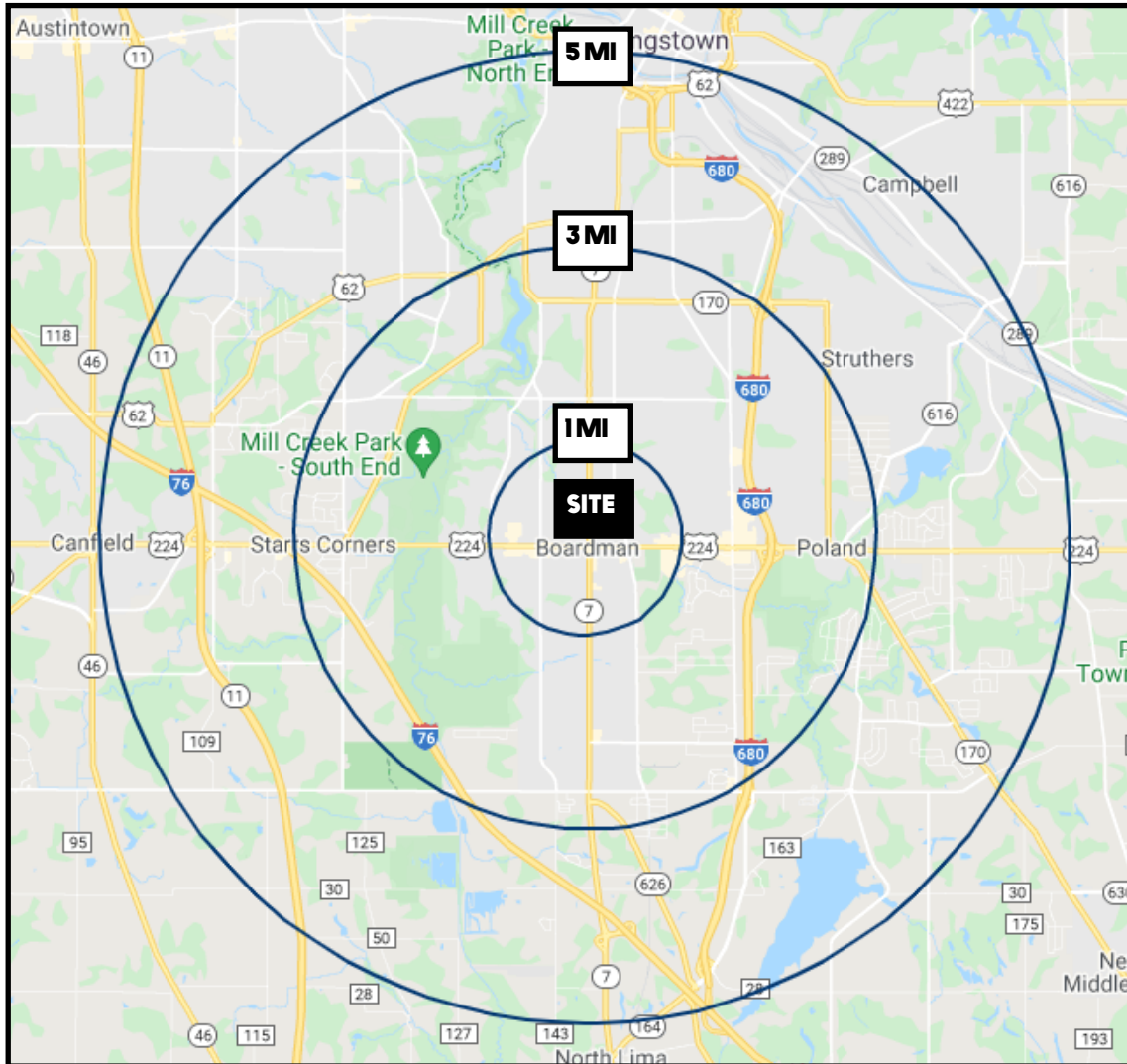

DEMOGRAPHICS	1 MI	3 MI	5 MI
POPULATION	7,316	54,010	115,080
HOUSEHOLDS	3,227	23,334	48,613
MEDIAN AGE	43	44	44
AVERAGE HH INCOME	\$70,733	\$72,330	\$68,035

SITE INFORMATION

LOCATION	Boardman Township Mahoning County
PROPERTY TYPE	Office
UTILITIES	Prorata, billed monthly
RESTROOMS	Common/shared
SIZE	First floor unit: 2,810 SF available
BASE RENT	\$9.00/SF
NNN CHARGES	\$3.00/SF

Office: 330.757.4889 | Fax: 330.294.5622 | 3830 Starr Centre Dr, Suite 2, Canfield, OH 44406