

LOCATION

1738 Boardman-Poland Rd, Boardman Twp, Ohio 44514

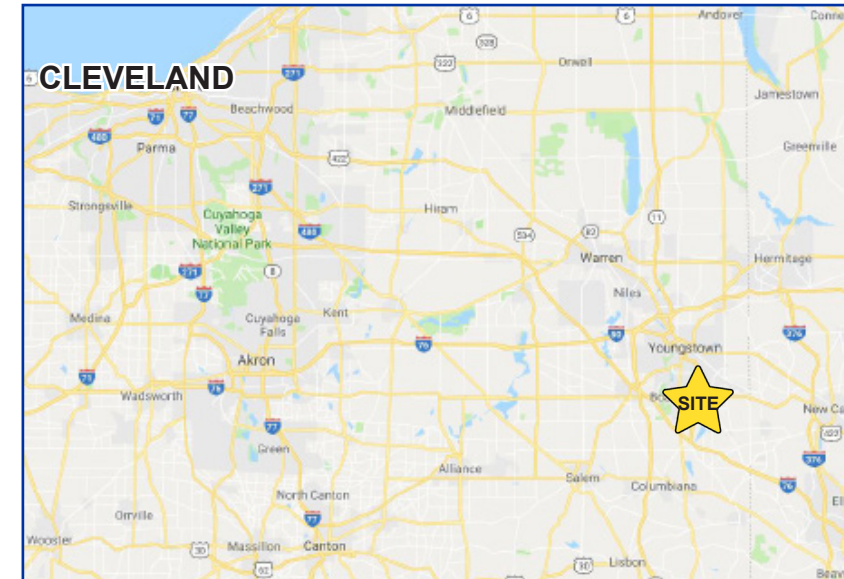

HIGHLIGHTS

- Former restaurant for sale with a full-sized industrial kitchen, includes equipment and liquor license
- Located on high-trafficed RT-224 next to the I-680 interchange
- Incredible opportunity for any restaurant space, sitting on 3.36 acres with ample parking

TRAFFIC

Boardman-Poland Rd = 19,642 VPD
I-680 = 36,011 VPD

CONTACT

BOB MCGOVERN

(330) 501-6500 bmcgovern@platzrealtygroup.com

MATTHEW WILSON

(330) 347-9677 mwilson@platzrealtygroup.com

Office: 330.757.4889 | Fax: 330.294.5622 | 3768 Boardman Cafield Rd, Canfield, OH 44406

[www.PLATZREALTYGROUP.com](http://www.platzrealtygroup.com)

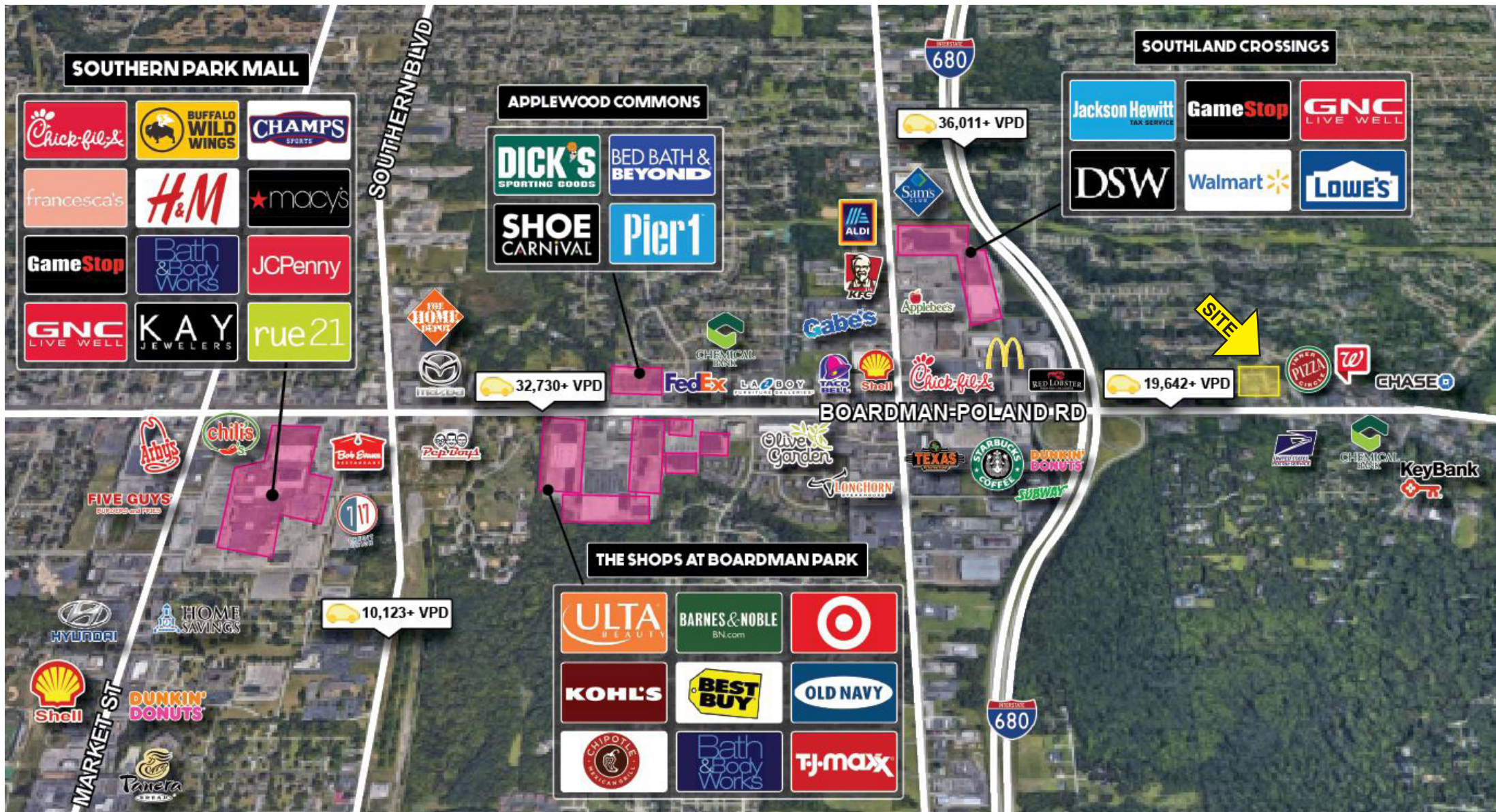

Office: 330.757.4889 | Fax: 330.294.5622 | 3768 Boardman Cafield Rd, Canfield, OH 44406

WWW.PLATZREALTYGROUP.COM

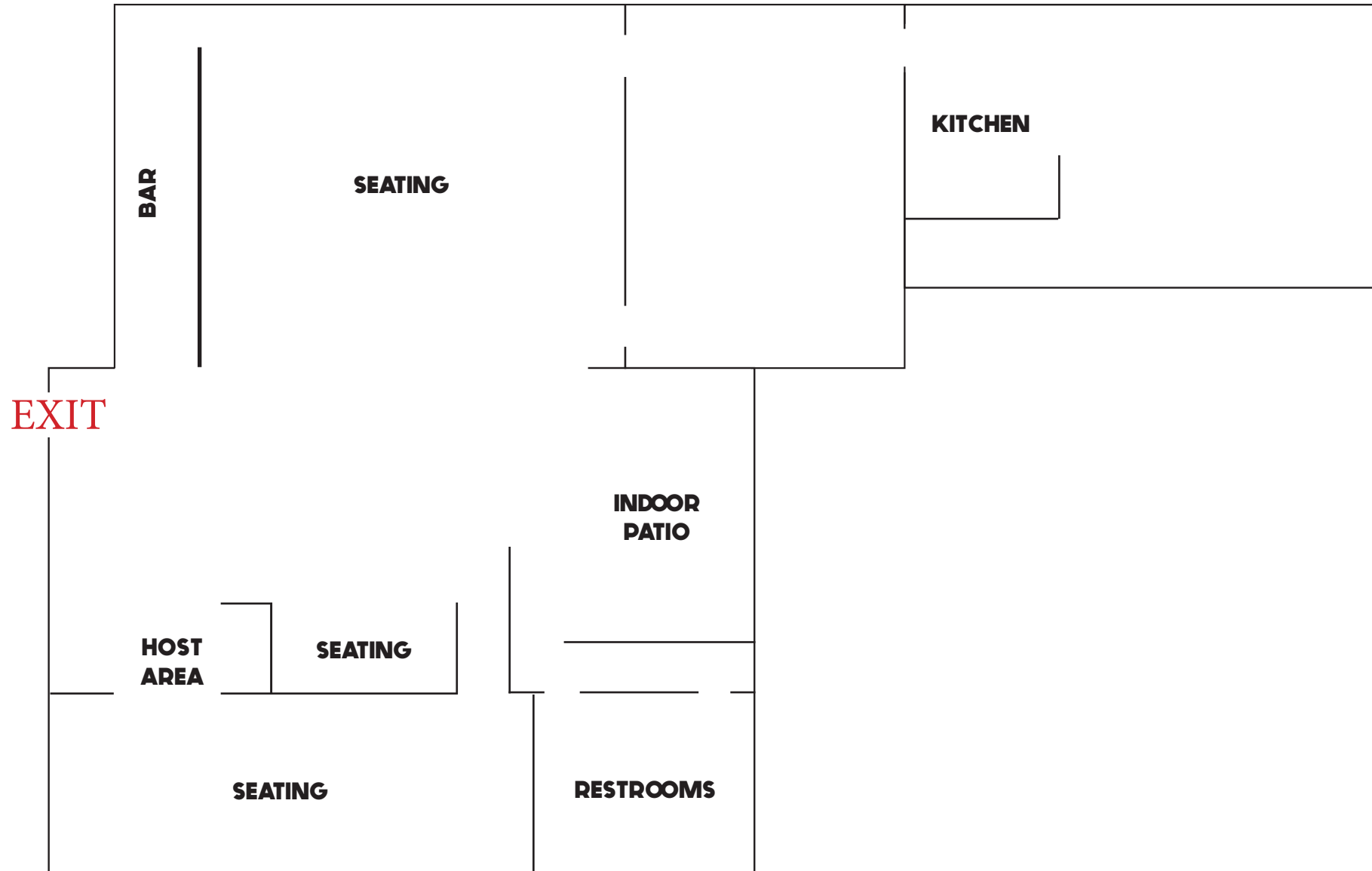

Office: 330.757.4889 | Fax: 330.294.5622 | 3768 Boardman Cafeld Rd, Canfield, OH 44406

www.PLATZREALTYGROUP.com



Office: 330.757.4889 | Fax: 330.294.5622 | 3768 Boardman Cafield Rd, Canfield, OH 44406

www.PLATZREALTYGROUP.com

The information presented was obtained from sources believed to be true and reliable. The Platz Realty Group makes no warranties or guarantees to the accuracy of the information.

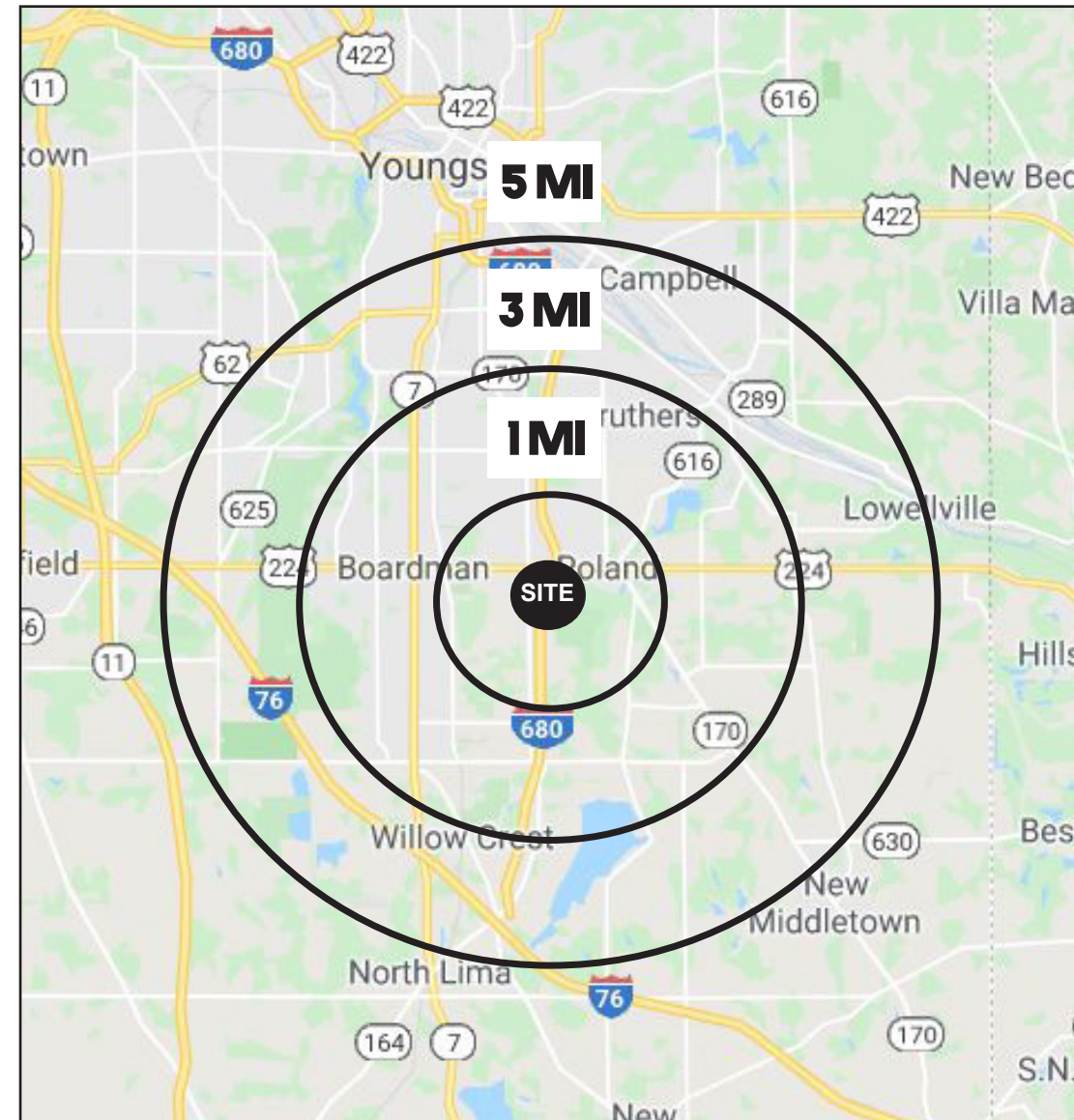

DEMOGRAPHICS	1 MI	3 MI	5 MI
POPULATION	4,592	52,693	104,539
HOUSEHOLDS	2,084	22,244	43,984
AVERAGE AGE	43.90	42.60	42.00
MEDIAN HH INCOME	\$66,269	\$51,977	\$42,411
DAYTIME EMPLOYEES	7,565	36,215	51,037

SITE INFORMATION

BUILDING SIZE	6,358 SF
YEAR RENOVATED	2010
ZONING	Commercial
SIGNAGE	Yes
ACREAGE	3.34 AC
PARKING	100+ Spaces
PRICE	\$1,200,000 \$15.00/SF Gross

Office: 330.757.4889 | Fax: 330.294.5622 | 3768 Boardman Cafield Rd, Canfield, OH 44406

www.PLATZREALTYGROUP.com